

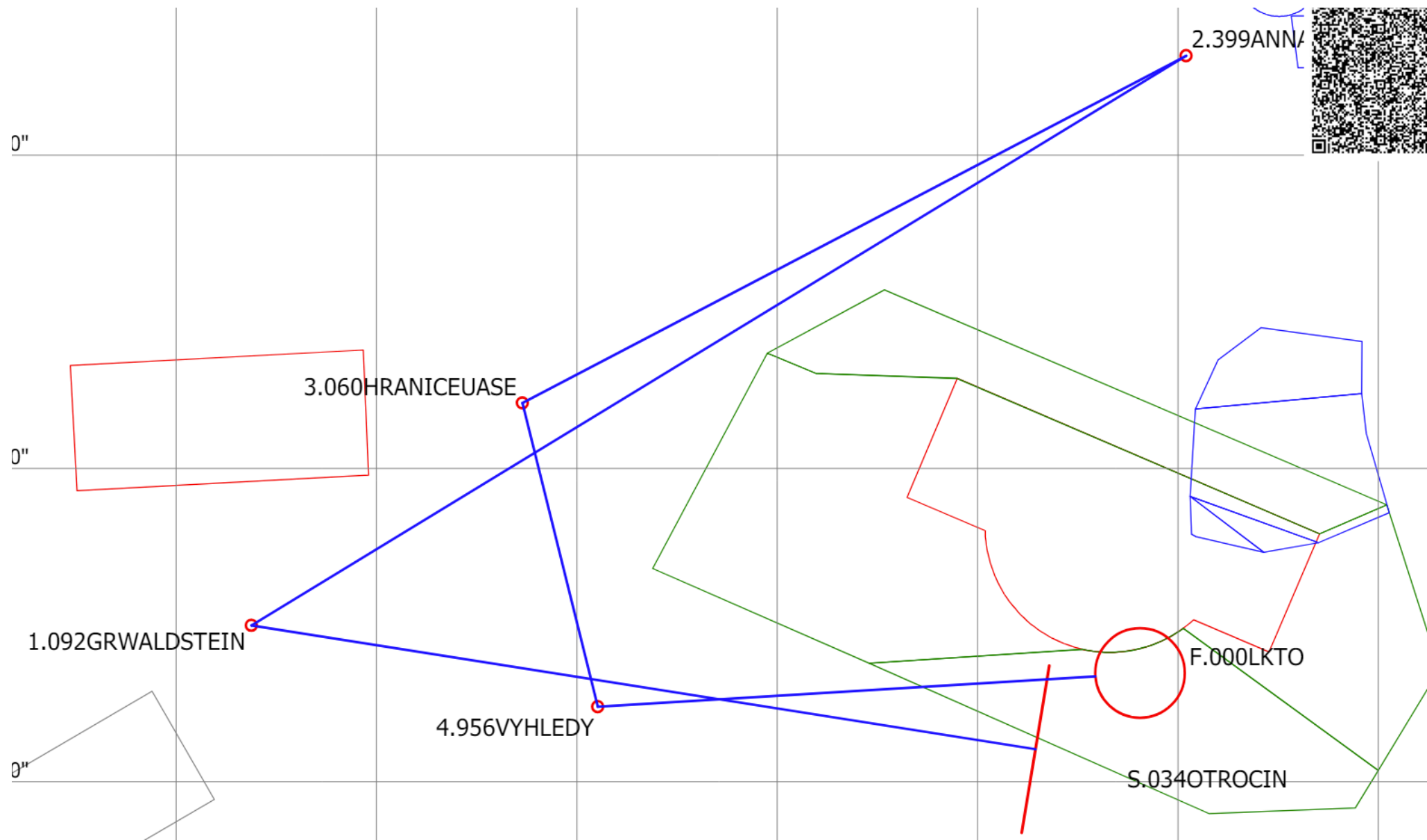

DAILY BRIEFING

COMPETITION DAY 10 – 18/06/2024

TASK CLUB



TASK CLUB

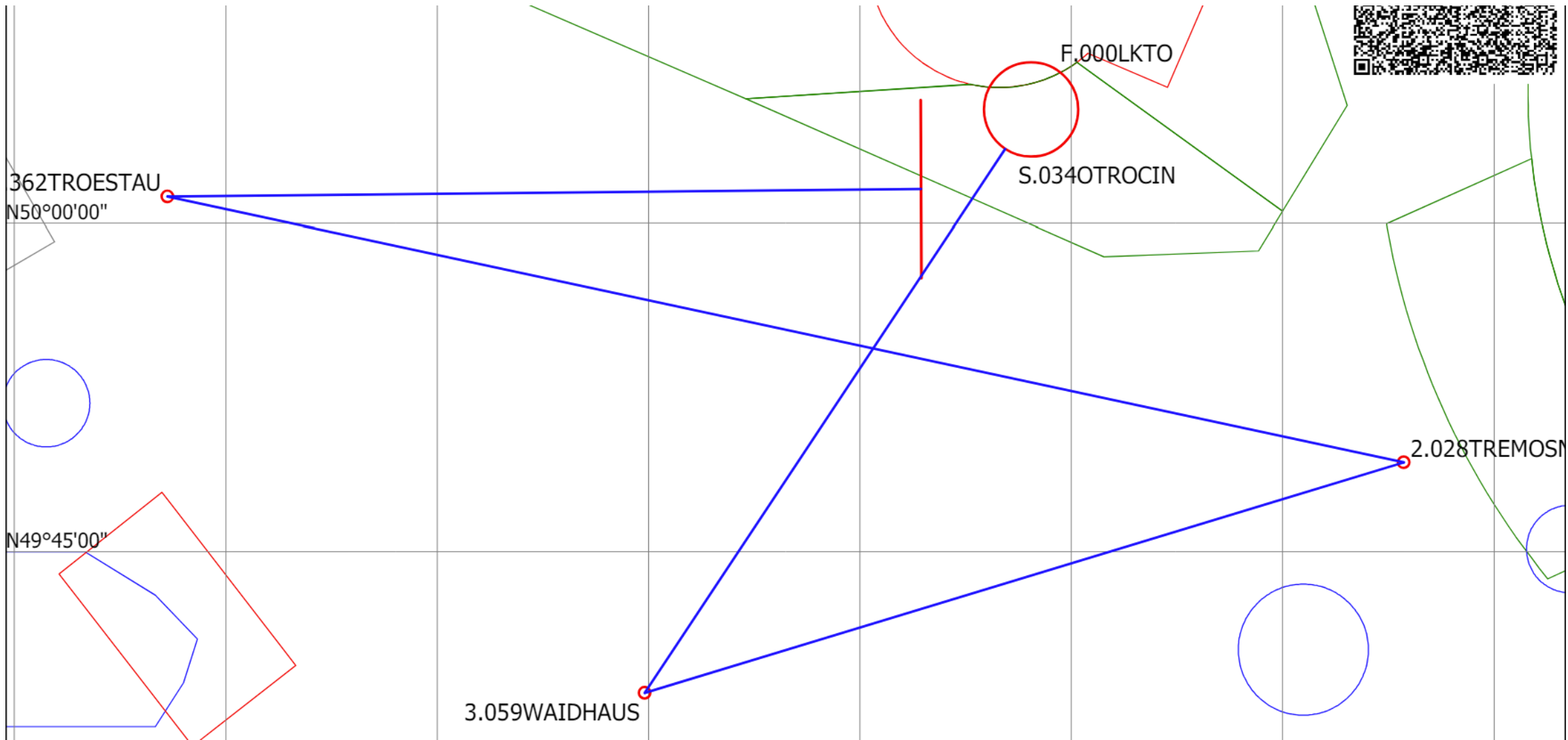

TASK 15M

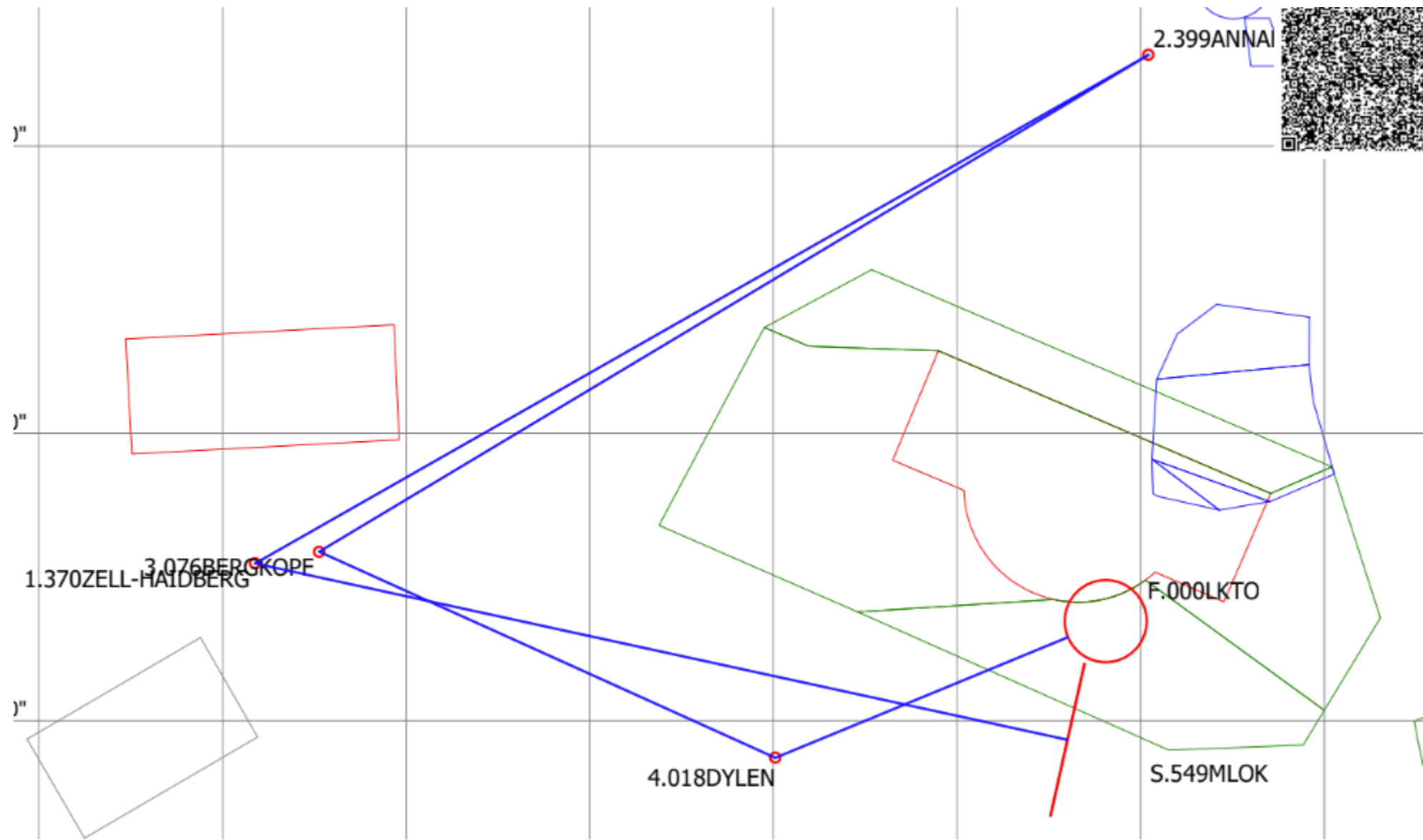

TASK 15M

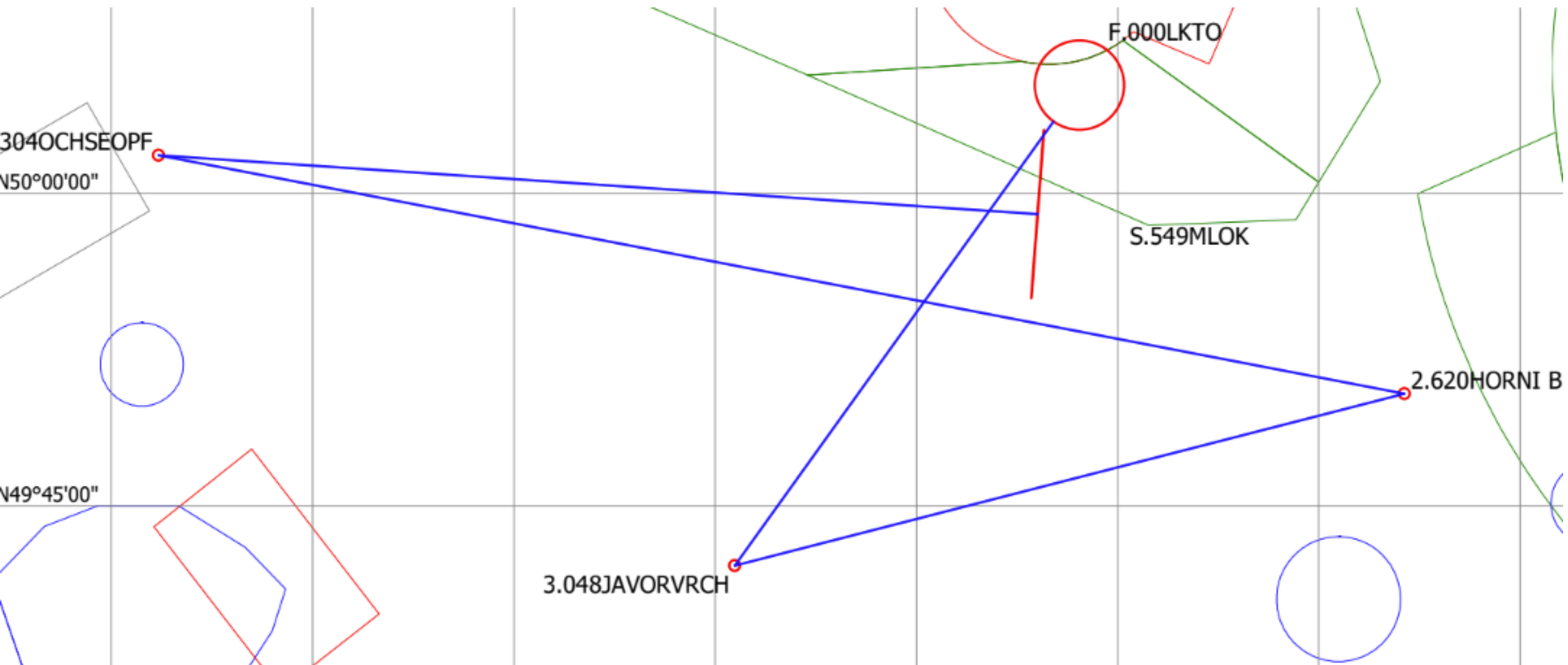

TASK OPEN

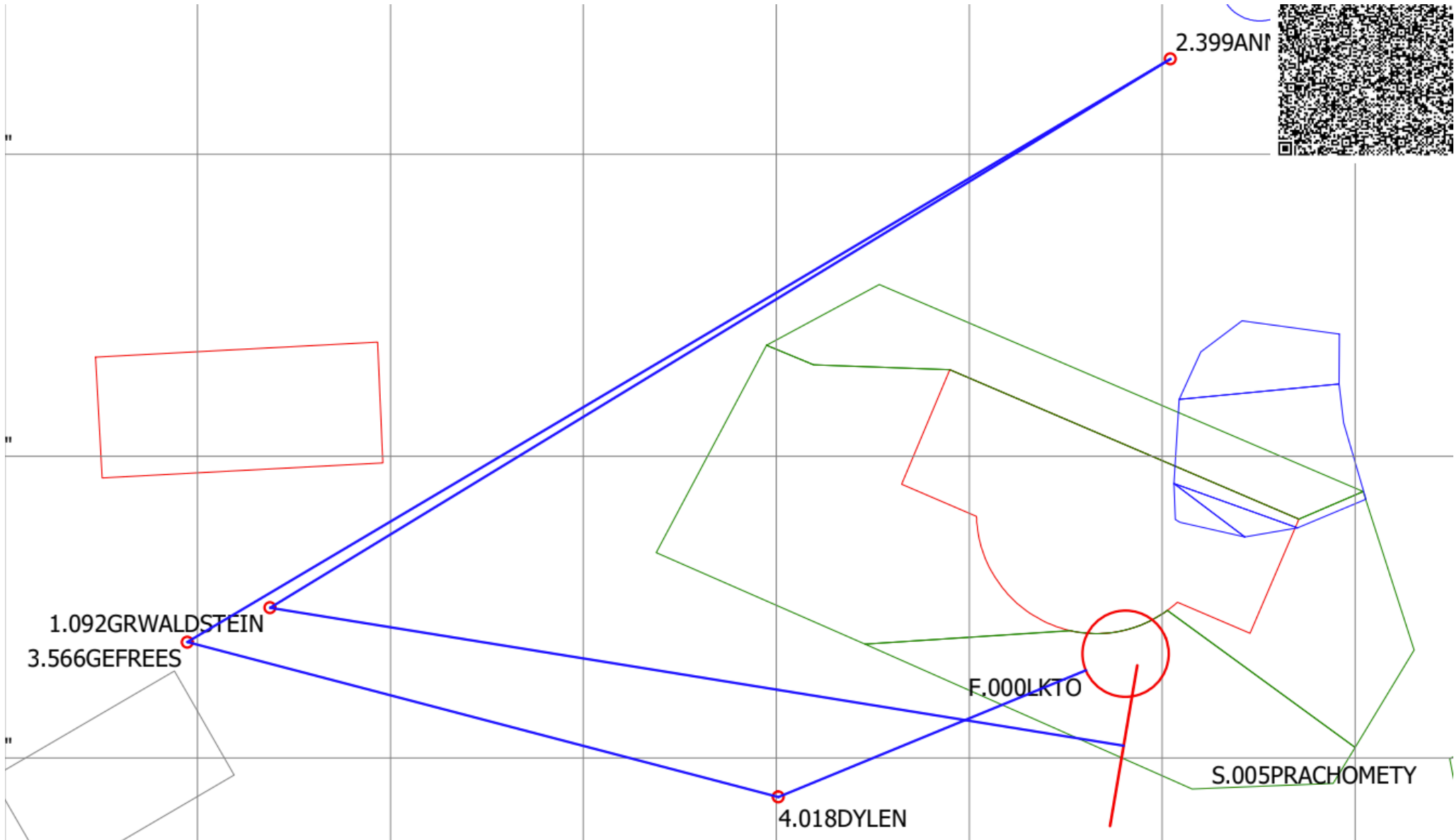

TASK OPEN

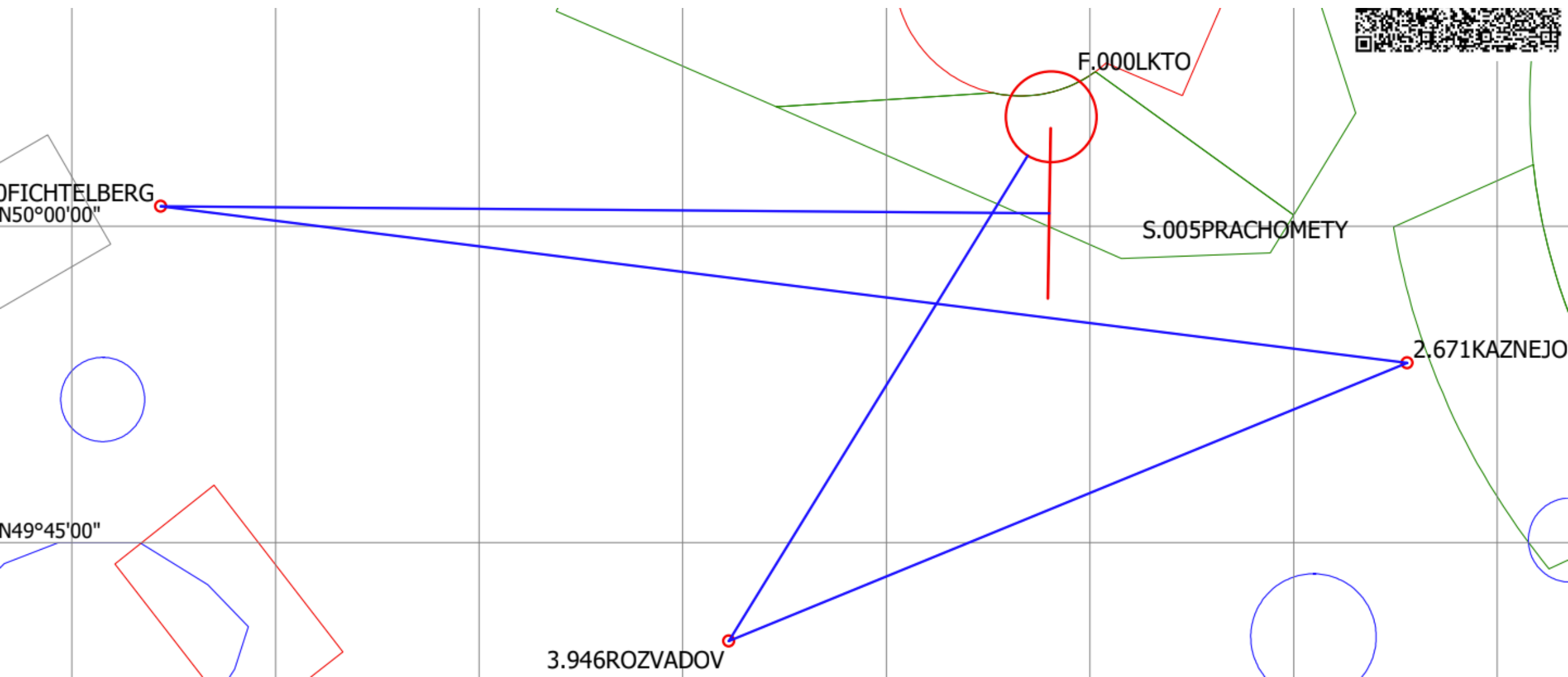

AIRSPACE

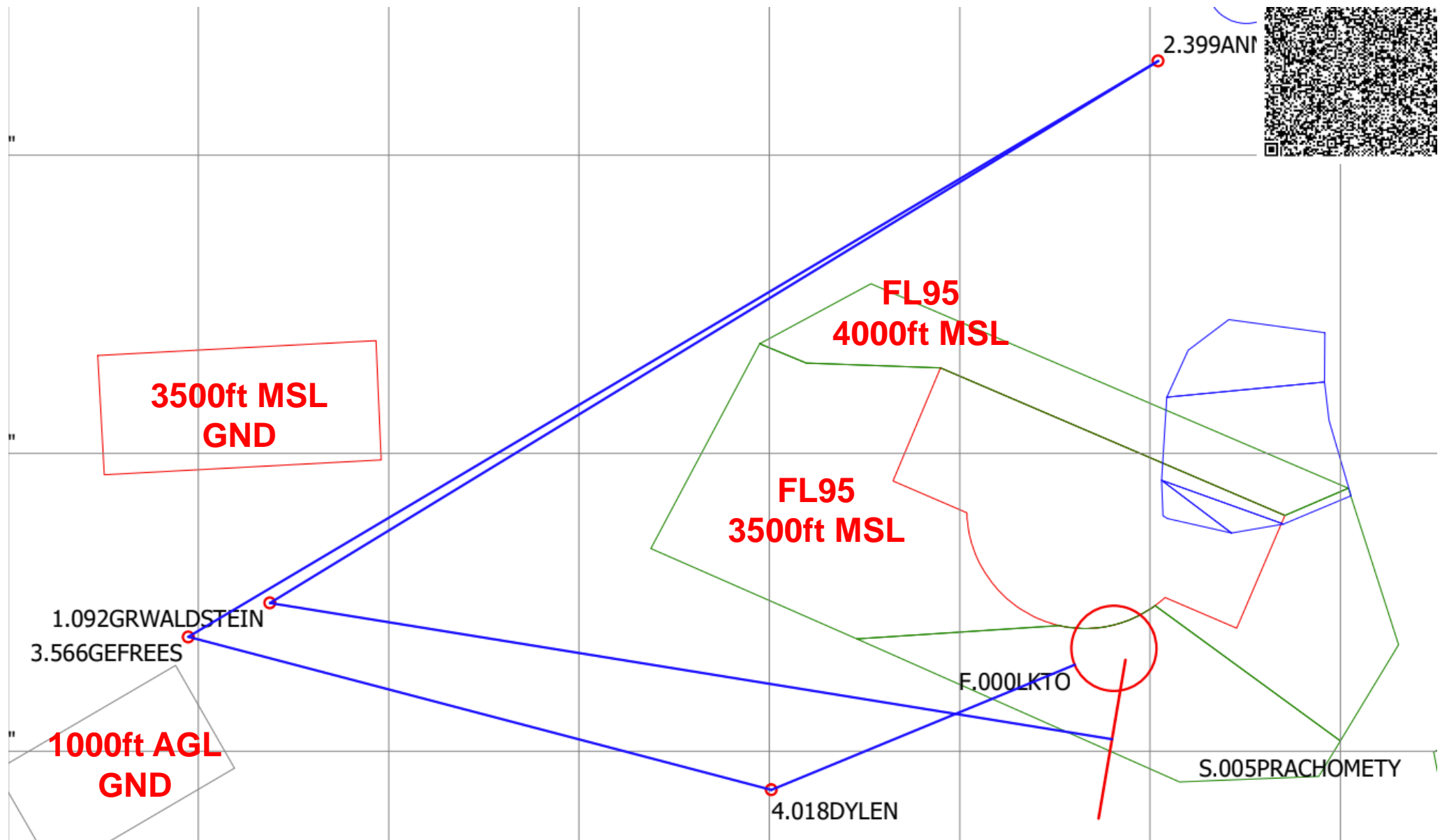
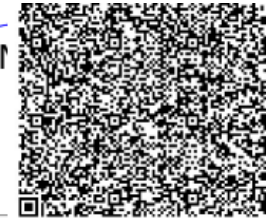

AIRSPACE

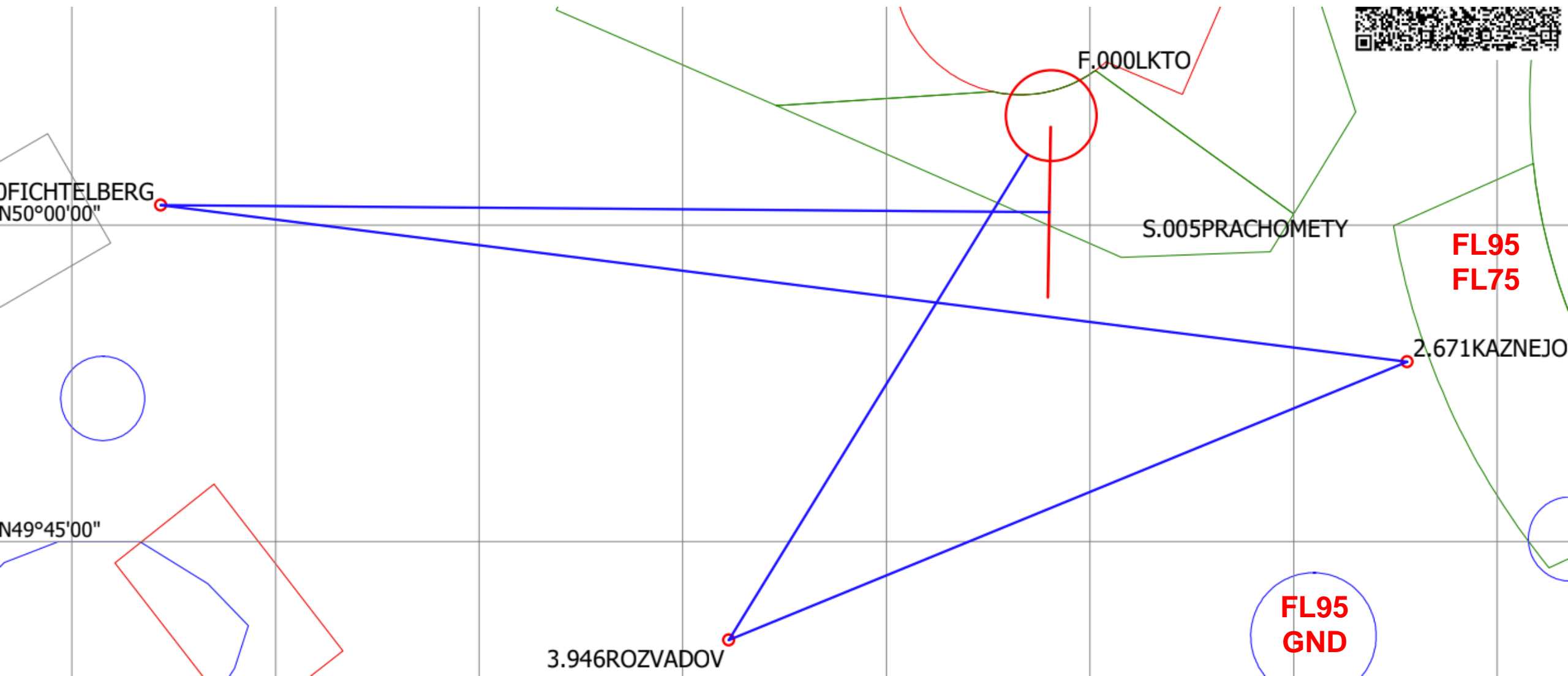

AIRSPACE

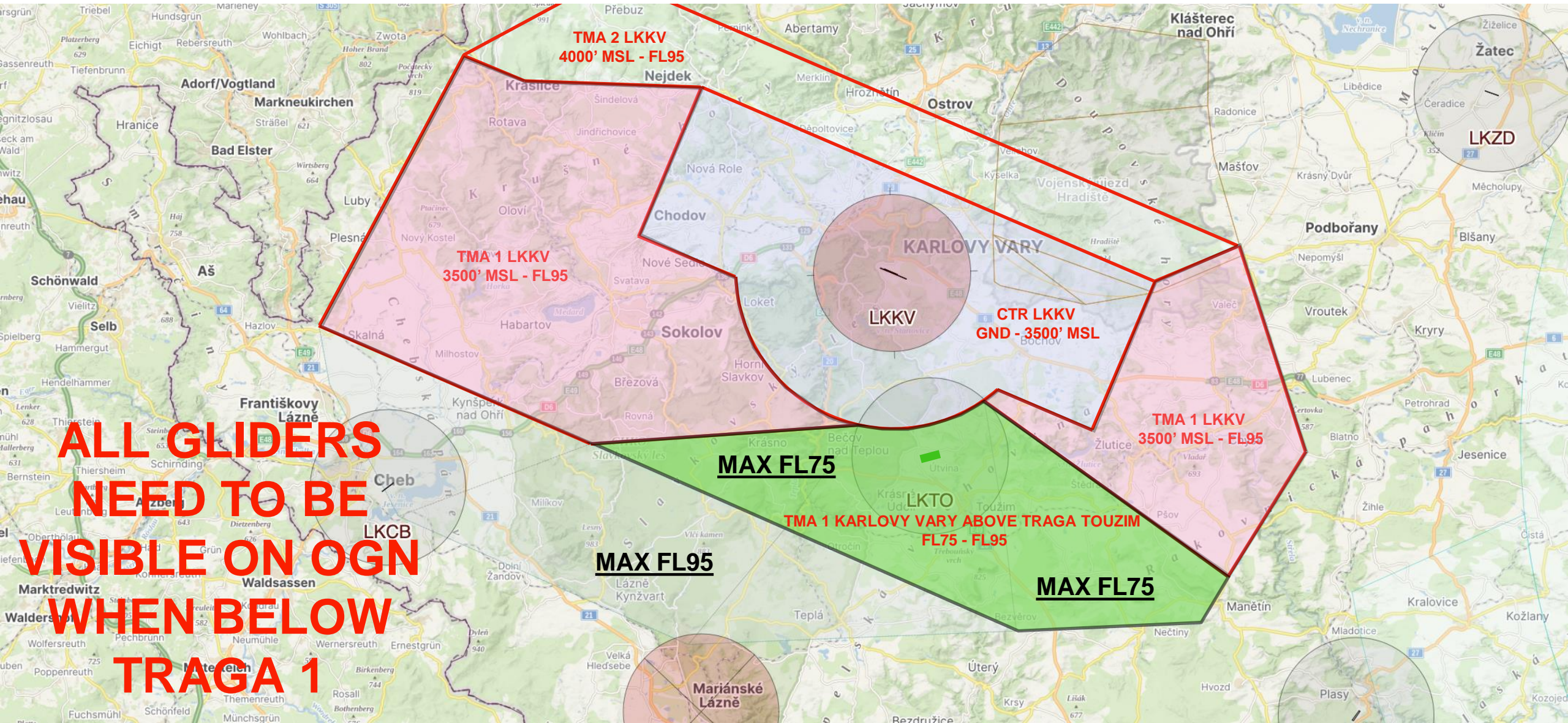

**ALL GLIDERS
NEED TO BE
VISIBLE ON OGN
WHEN BELOW
TRAGA 1**

TAKE-OFF RWY 26



TAKE-OFF RWY 26

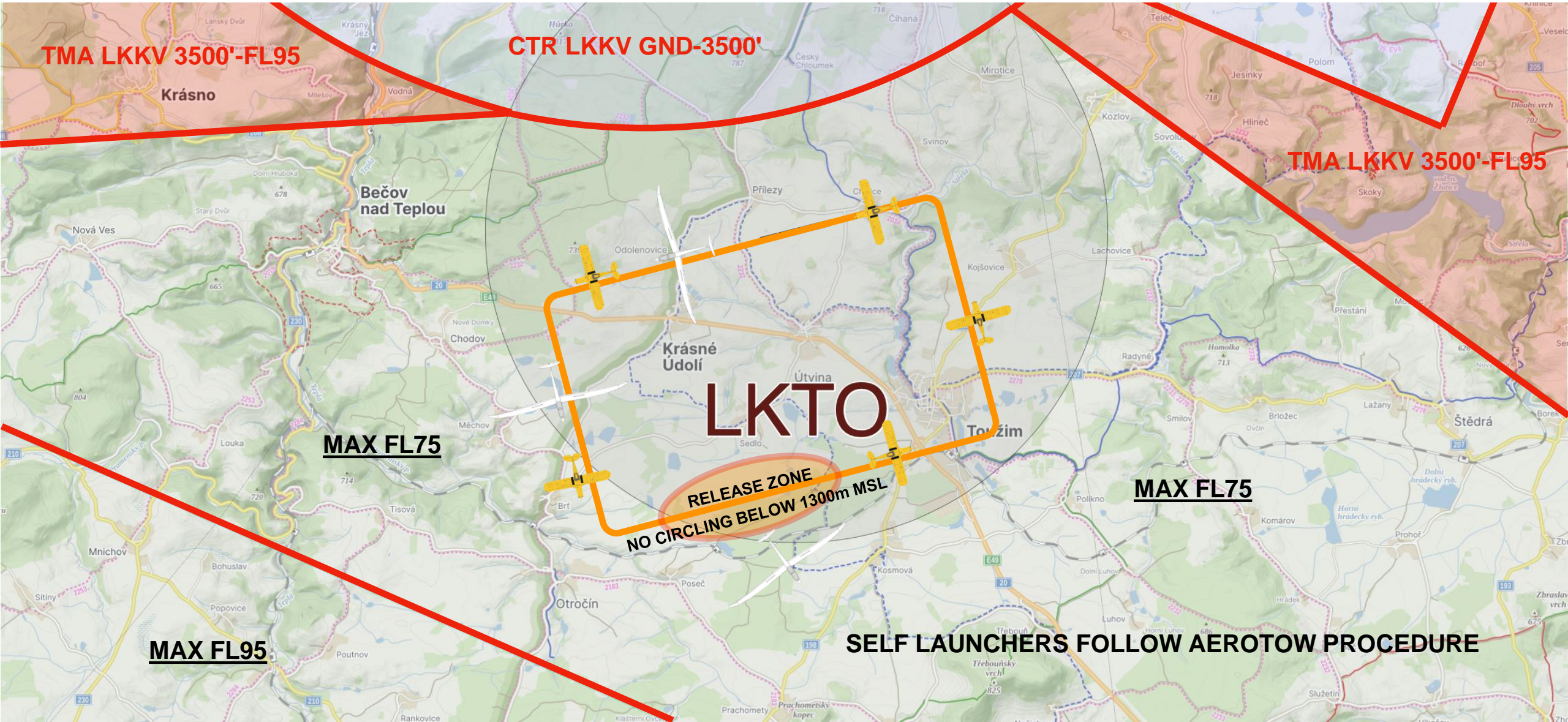

TMA LKKV 3500'-FL95

CTR LKKV GND-3500'

TMA LKKV 3500'-FL95

MAX FL75

LKTO

RELEASE ZONE
NO CIRCLING BELOW 1300m MSL

MAX FL75

MAX FL95

SELF LAUNCHERS FOLLOW AEROTOW PROCEDURE

FINISH RWY 08

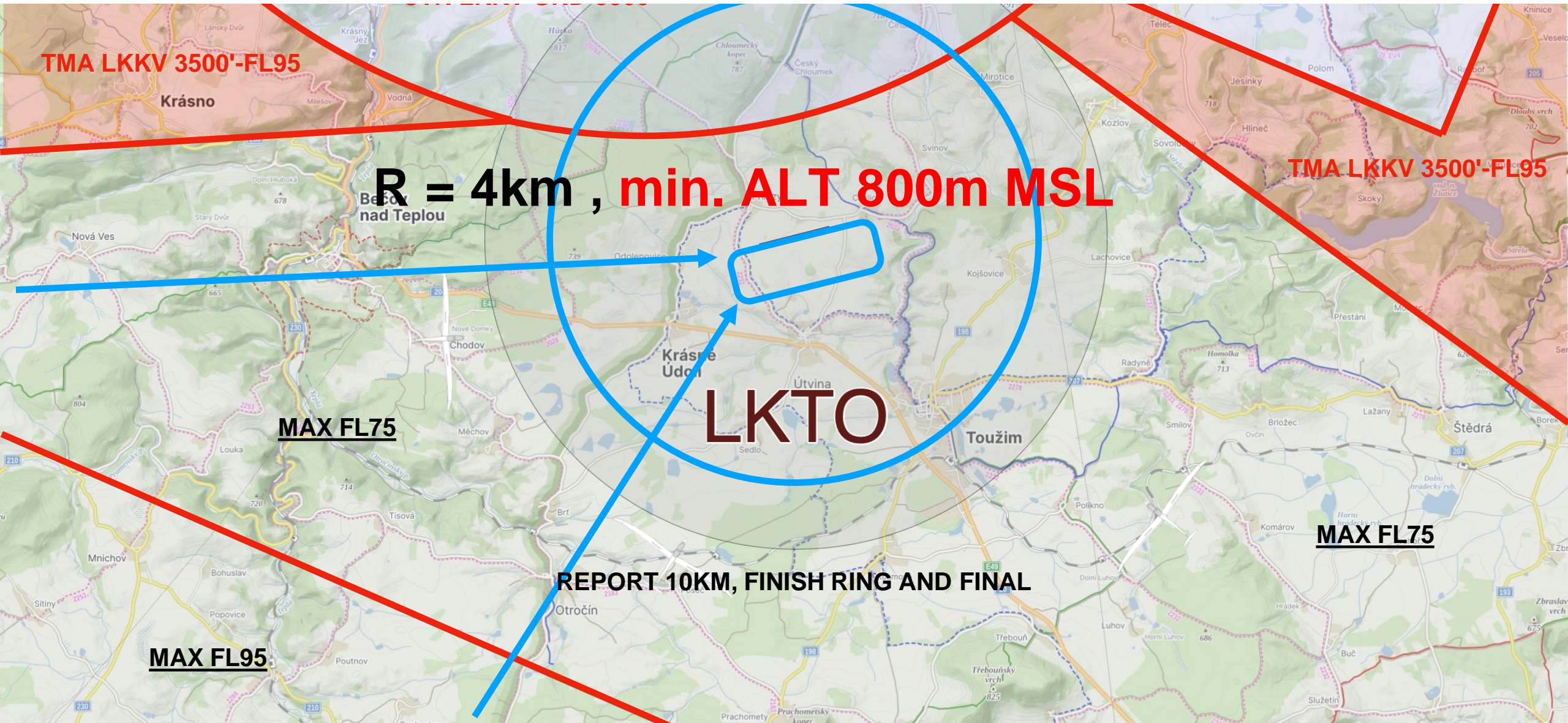

TMA LKKV 3500'-FL95

Krásno

R = 4km , min. ALT 800m MSL

TMA LKKV 3500'-FL95

MAX FL75

LKTO

Toužim

MAX FL75

MAX FL95

REPORT 10KM, FINISH RING AND FINAL

LANDING RWY 08



ENERGY CONTROL



- MAXIMUM START ALTITUDE –
2000m MSL

- MAXIMUM START GROUNDSPEED –
170 km/h

PEV START



- NOT IN USE TODAY

INFORMATION FOR TODAY



- START LINE WILL OPEN 30 MINUTES
AFTER LAST LAUNCH IN CLASS

FILE DELIVERY



- SEND ALL FILES TO IGC@POHODA.COM
- 45 MINUTES FOR FILE DELIVERY
- **INCLUDE CN IN EMAIL SUBJECT**
- 1 SECOND FIX RATE
- ENSURE CORRECT FILE HEADER

INFORMATION FOR TODAY



- RUNWAY IN USE: 26
- RWY FOR LANDING: 08
- FIRST LAUNCH: 11:00
- TASK A IS VALID
- COMPETITION FREQ: 130.340



CZECH **GLIDING** CHAMPIONSHIP

TOUŽIM | 2024



NÁRODNÍ
SPORTOVNÍ
AGENTURA

